

SHADY OASIS

Perennial Garden Collection



Woodland Wildflower Retreat

With a little artifice in the form of site preparation, easy-to-obtain flowering perennials, and a planting diagram, you can have a naturalistic woodland garden that will look as though Mother Nature placed it there. In this plan our definition of "wildflower" is a little broader than usual; we have included some perennials that are close relatives or descendants of native American wildflowers—refined through breeding to achieve a longer period of bloom or more variety of color. The ideal site for your shady garden is near the edge of a high canopy of deciduous trees, which shields the garden from the scorching midday sun. Since very few plants will do well in deep shade, try to situate your wildflower bed in the brightest part of a wooded area. It's also important for this site to have adequate moisture, so applying a layer of leaf mulch or any other finely cut top-dressing is recommended. Several of the perennials in this plan are exuberant growers, so keep your eye on the *Monarda* and *Tradescantia*. Every other year or so the discipline of a spade might be required to keep them in bounds. Plant in groups of three except where indicated.

APPROXIMATE
DIMENSIONS
17' x 7'

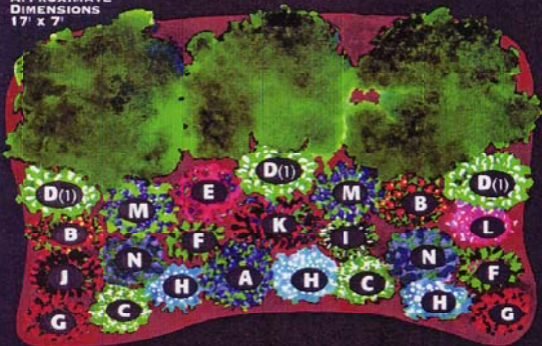

Illustration by David Anderson

- | | | | |
|---|---------------------------------------|---|-------------------------------------|
| A | <i>Aquilegia</i> 'Blue Bird' | H | <i>Lamium</i> 'White Nancy' |
| B | <i>Aquilegia</i> 'Cardinal' | I | <i>Lysimachia</i> <i>dethroides</i> |
| C | <i>Aquilegia</i> 'Dove' | J | <i>Monarda</i> 'Marshall's Delight' |
| D | <i>Aruncus</i> <i>dioicus</i> | K | <i>Phlox</i> 'David' |
| E | <i>Astilbe</i> <i>taquetii</i> | L | <i>Physostegia</i> 'Rosea' |
| F | <i>Chelone</i> <i>obliqua</i> | M | <i>Polemonium</i> 'Bris D'Anjou' |
| G | <i>Heuchera</i> 'Bressingham Hybrids' | N | <i>Tradescantia</i> |